

December 19, 2008
Mori Building Co., Ltd.

Start of Construction of Nagatacho Sanno Mori Building

In advance of the January 2009 start of construction on the main structure of the Nagatacho Sanno Mori Building in the Nagatacho district of Tokyo's Chiyoda Ward, Mori Building Co., Ltd. held a building-site ground sanctification ceremony (*jichinsai*) today, Friday, December 19.

This building is located in the Akasaka-Nagatacho area, a business hub. With six subway lines converging in the vicinity, this highly convenient site is only a two-minute walk from the Tameike-Sanno and Kokkaigijidomae Tokyo Metro stations. Bordering on Hie Shrine, the area is also notable for its extensive greenery.

The Nagatacho Sanno Mori Building is an office building rising 8 floors aboveground, with a total floor area of about 5,180 square meters. Featuring 3.0-meter ceilings, the standard leased floors will have a spacious feel, and the strong earthquake resistance (vibration damping), security functions, and design sense will contribute to the building grade.

We are moving forward with the work with a target completion of the spring of 2010.

Features

- 400-square-meter roof garden sharing greenery with adjacent Hie Shrine.
- High-range specs, earthquake resistance, and strong security.
- Business hub
Highly convenient access with six converging subway lines.
- Facade combining design sense and reduced energy consumption.



Conceptual drawing

(The above conceptual image perspective may differ from actual)

For more information, please contact:

Mori Building Co., Ltd., Public Relations (attn.: Morisawa, Ikki)

Address: Roppongi Hills Mori Tower, P.O. Box 1, 6-10-1 Roppongi, Minato-ku, Tokyo
106-6155, Japan

Tel +81-3-6406-6606 Fax +81-3-6406-9306 E-mail koho@mori.co.jp

■400-square-meter roof garden sharing greenery with adjacent Hie Shrine

The top of the building will feature a roof garden with various greenery. In concert with the deep forest of adjacent Hie Shrine, the roof garden will provide a refreshing space for office workers while also contributing to a reduction of the heat-island effect in the city center.



■High-range specs, earthquake resistance, and strong security

The 3.0-meter ceilings on standard leased floors create a spacious feel, and, with 5.0-meter ceilings, the first-floor space is suitable for showroom use. Despite its relatively modest size, the building features a vibration damping structure, and there are three levels of security (building entrance, elevator car, office door).

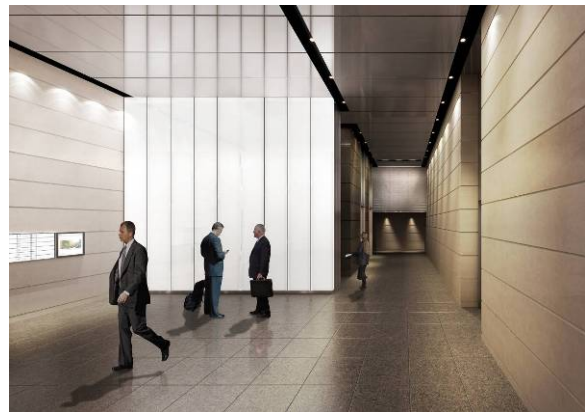

■Business hub: Highly convenient access with six converging subway lines

This building is located in the Akasaka-Nagatacho area, a business hub. It is an extremely convenient area, with six subway lines converging in the vicinity (Tokyo Metro Namboku, Chiyoda, Marunouchi, Ginza, Hanzomon, and Yurakucho lines), and the Tokyo Metro Tameike-Sanno and Kokkaigijidomae stations are only a two-minute walk away.



■Facade combining design sense and reduced energy consumption

The east and west facades consist of vertical louvers limiting the effects of the sun's rays. For a sophisticated design worthy of the building's Nagatacho location, the facades create a series of vertical lines while preserving the view. Since the air conditioning burden is highest on the east and west sides, the use of sun-blocking louvers there also serves to increase the building's energy efficiency.

Project summary

Name: Nagatacho Sanno Mori Building
Location: 57-3, 58-1, Nagatacho 2-chome, Chiyoda-ku, Tokyo
Site area: 945.52 square meters
Building area: 875 square meters
Total floor area: 5,180 square meters
Floors: 8 above ground
Uses: Offices
Standard-floor leasable area: Approximately 680 square meters
Total leasable area: Approximately 3,600 square meters
Building height: 34.6 meters
Structure: Steel frame (steel-reinforced concrete in some areas)
Owner: Mori Building Co., Ltd.
Designer: Kume Sekkei Co., Ltd.
Contractor: SHIMIZU CORPORATION

Map of project location

