

## **Mori Building Opens Membership Facility for Collaboration on Societal Issues in Toranomon Hills' Glass Rock Building**

*Co-creation hub for cross-sector collaboration among businesses, government agencies, NGOs and citizens*

Tokyo, April 7, 2025 — Mori Building Co., Ltd., Japan's leading urban landscape developer, announced today that the Glass Rock – Social Action Community, a membership facility for cross-sector collaborations on diverse issues in modern society, will open April 9 on the B1 and 4th floors of the Glass Rock building in Toranomon Hills. The opening of the co-creation hub and seven retail stores completes the development of Toranomon Hills Station Tower.



Glass Rock building in the heart of Toranomon Hills



Glass Rock - Social Action Community, a platform and mechanism for addressing societal issues

### **New hub for addressing issues through cross-sector collaboration**

Modern society has been undergoing dramatic changes in recent years, including workforce declines due to low birth rates and aging populations in Japan and other countries, the intersection of technology and ethics, climate change, poverty and wealth inequality, and gender issues. Many of these issues are too difficult for by any single organization or sector to solve, and thus require cross-sector collaboration and co-creation among corporations, government agencies, NPOs, NGOs and individuals.

The new Glass Rock – Social Action Community will serve as a members-only hub dedicated to addressing pressing issues through cross-sector collaboration and co-creation. Spanning some 890 square meters on two floors (B1 and 4th), it will provide a platform for networking supported by expert facilitators. It will also offer programs and events for practical learning and dialogue. In addition, events and gallery exhibitions will help broaden perspectives on targeted issues. Through these platforms and mechanisms, the hub will facilitate cross-sector collaboration and co-creation for innovative solutions that support a more sustainable world.

### **Enhanced connectivity and walkability in Toranomon Hills**

Toranomon Hills is a new transportation hub in the heart of Tokyo, with a large station plaza comprehensively integrated with Tokyo's Loop Road No. 2, a large bus terminal, and Toranomon Hills Station on the Tokyo Metro Hibiya Line. In addition, a 20-meter-wide pedestrian deck and other facilities help strengthen and expand the area's multi-layered transportation network at ground, underground and deck levels.

And now, Toranomon Hills' connectivity have been further enhanced with the opening of the Glass Rock mixed-use building, featuring seven floors (four above ground) and a total floor area of 8,800 m<sup>2</sup>. Glass Rock is traversed by T-Deck, a 20-meter-wide pedestrian walkway linking Mori Tower and Station Tower, further enhancing transportation accessibility and circulation within Toranomon Hills.

Going forward, Mori Building expects to strengthen Toranomon Hills as a major international hub and global business center attracting global players with diverse urban functions and contributing to Tokyo's growing international magnetism.

## Toranomon Hills area

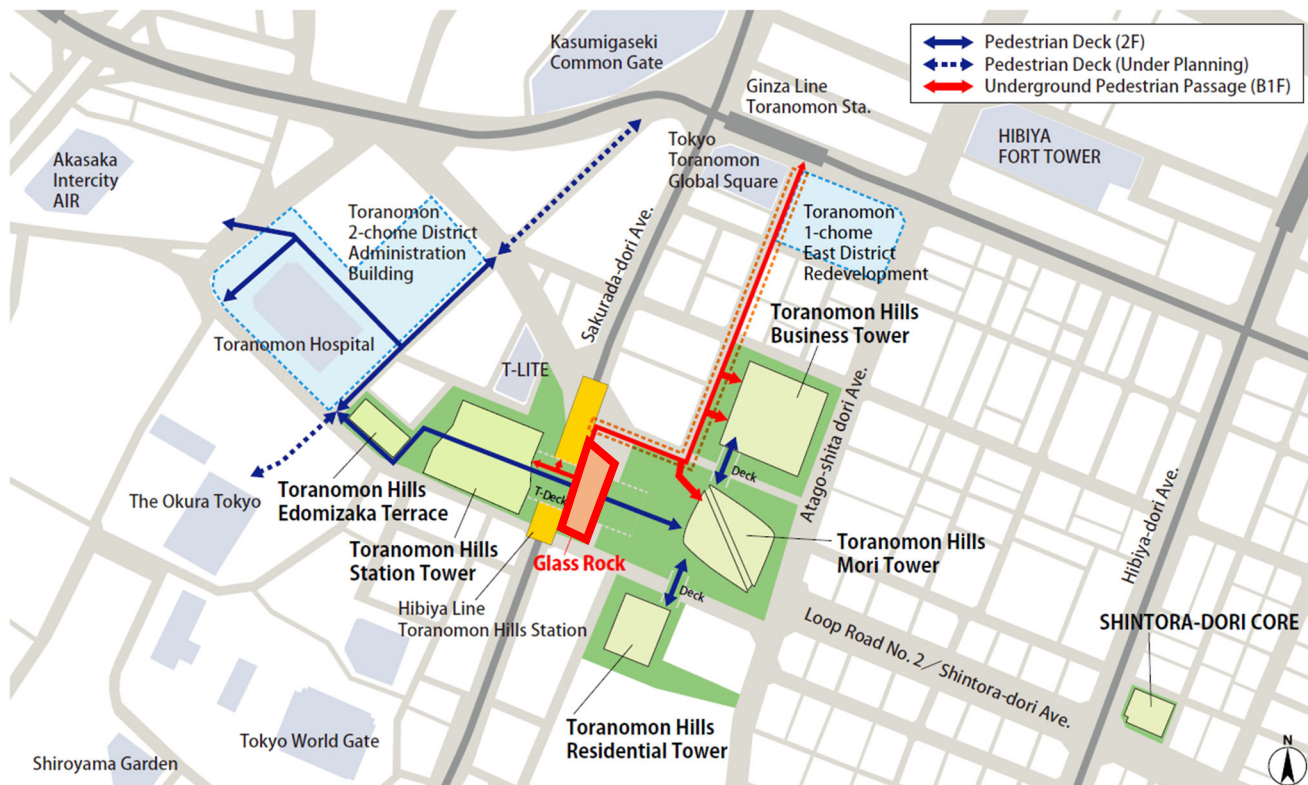

## Glass Rock floor map

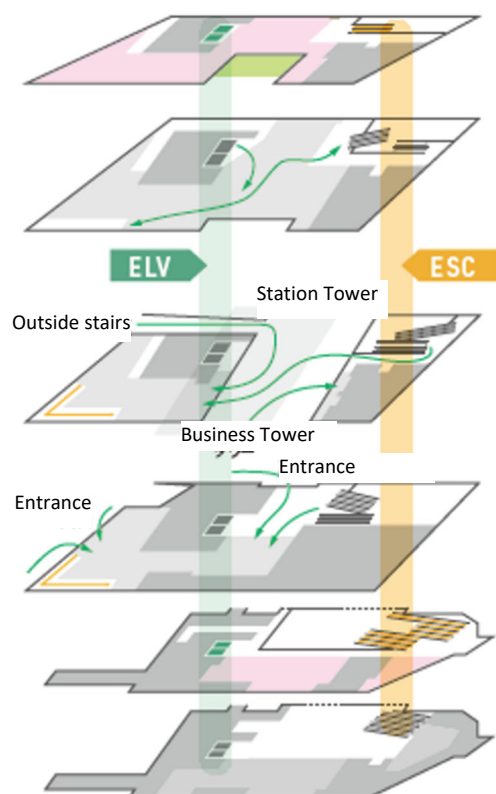

### 4F GLASS ROCK

Social Action Community

Partners Lounge

### 3F magmabooks [Multi-concept bookstore]

### 2F magmabooks [Multi-concept bookstore] Uchu Brewing [Craft beer]

### 1F TULLY'S COFFEE&TEA [Cafe] BENOIT NIHANT [Chocolatier] ROSE GALLERY [Specialty shop for rose]

### B1F GLASS ROCK

Social Action Community

Members Lounge / Gallery

### B2F BANANA REPUBLIC [Men's and women's fashion] OWNDAYS [Eyeware]

## **Glass Rock membership facility for connecting, learning and expanding**

By providing spaces for connecting, mechanisms for learning and channels for expanding, the facility will foster cross-sector collaboration and co-creation to drive innovative solutions. The planning and management of the facility will be overseen by Keio University Professor Hiroaki Miyata, who will serve as an Advisor.

### **Connecting:**

#### **Collaboration and co-creation through community building and activation**



The community will form a hub where individuals from diverse fields who share a desire to improve society will meet frequently. A Community Manager will help activate the community and a Co-creation Coordinator will move projects forward by connecting and supporting individuals and organizations for in-depth discussions.

The Co-creation Coordinators will include Ryuta Kosuge, who was recruited by the Ministry of Economy, Trade and Industry's to support a flying car project from a private-sector perspective, and Naoki Hashimoto, a former Ministry of Economy, Trade and Industry official who studied at an American art graduate school to promote policymaking from a design perspective. Also, Hitokara Media Inc. will serve as an Operational Partner to facilitate community operations involving diverse individuals.

### **Learning:**

#### **Programs and events for exploring solutions**



Various programs and events will support the development of actionable solutions. The programs will create learning experiences by bringing together case studies, knowledge and expertise from corporations, governmental bodies, NPOs and NGOs. More than 30 such entities, each with frontline knowledge and experience in addressing diverse issues, will participate as Co-creation Partners. They will support collaborative projects to consider pressing issues, enhance problem clarity, provide venues for addressing challenges, and organize events and workshops where members can experience these environments firsthand. These collaborations and shared experiences will leverage the facility's resources to help members

gain insights, share knowledge and pursue co-creation. Also, the framework will encourage members to translate learning into practical, solutions-oriented action.

### **Expanding:**

#### **Communication platform to deepen understanding and encourage collective action**

An open community is essential to solving major issues in society. The facility's galleries and recording studios will allow members to exchange information to foster understanding and empathy among diverse stakeholders and supporters, ultimately to build momentum for new initiatives.



Visualizing the activities of members through events and exhibitions

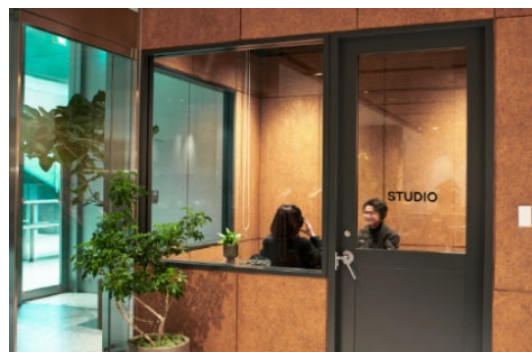

Broadcasting real voices from the frontlines of social issues with a fully equipped audio recording studio



### Overview of Glass Rock Facility

The 4th floor of Glass Rock will be home to the Partners Lounge, which will be used by corporate members and co-creation partners, and the B1 floor will host the Members Lounge and Gallery, which will be available to all members.

#### Partners Lounge (4th floor; 569 m<sup>2</sup>)



This is where the Community's 100 corporate partners (about 300 people) and over 30 co-creation partners will gather to interact and explore co-creation opportunities on a daily basis. The lounge will also be available for seminars and workshops, including the "Take Off Program" and "X Roadmaps" for corporate members. In addition, the TANA library in a corner of the lounge will also help to connect people, ideas and action.

#### Members Lounge (B1F; 258m<sup>2</sup>)



This lounge will be open to all members, both corporate and individual, for co-creation. People from diverse sectors will be able to interact to consider new initiatives and opportunities, and the facility's Community Manager will help to facilitate communication. There will even be a central kitchen to encourage additional interaction. The layout can be transformed into a theater-style setting for seminars and study groups of up to 70 people. Also, a soundproof studio will be available for audio recordings of people talking about solutions to key issues in society.

#### Gallery (B1F; 63m<sup>2</sup>)



The Gallery, which faces the plaza in front of Toranomon Hills Station, will host events and exhibitions where members can showcase various initiatives. From April 7 to June 30, an exhibition entitled "The Real Truth about Sustainability: From 'I Can't Do It Alone' to 'I Can Do It!,'" will present sustainability issues and responses detailed in member companies' integrated reports.\* *Ideas For Good*, a web magazine focused on innovative ideas, will support the exhibition with examples of actions that contribute to societal advancement. In addition, visitors will vote on the best ideas for personal action to achieve a sustainable future, and the results will be shared with the general public.

\*Reports that disclose corporate strategy, governance, performance, and outlooks.



### **Programs and Collaborations with magmabooks Bookstore**

The Glass Rock – Social Action Community will develop programs to foster various skills for cross-sector co-creation, including dialogue, collaboration and “future thinking” (thinking about possible actions by first considering desired outcomes and then reflecting on the present). In addition, workshops will be organized to gather member companies, government ministries, local governments, NPOs, NGOs and academia to share case studies, knowledge and know-how to learn from each other. In this regard, collaborations with magmabooks bookstore on the 2nd and 3rd floors will expand learning opportunities for non-members.



Starting in July 2025, Ai Nakajima, Director and founding Editor-in-Chief of the Japanese edition of the Stanford Social Innovation Review, will oversee the curriculum. The program will include initiatives such as the Take Off Program (TOP), where participants will explore frameworks, methods, challenges and case studies for cross-sector co-creation through dialogue with practitioners. Additionally, X Roadmaps, led by VISIONGRAPH Inc., a content partner that also serves as the official representative for SXSW Japan, will facilitate discussions on future visions and action plans from the present. Participants will have opportunities to

meet like-minded people and build relationships to for solution creation from a medium- to long-term perspective, including through one-day workshops and seminars.

### **Glass Rock Opening Program Series**

- April 21, 2025: “What for-profit and non-profit organizations can do—Commercializing social-issue solutions”  
Speakers: Borderless Japan, Arc & Beyond, and Chikinkai  
Moderator: Ai Nakajima (Editor and Glass Rock Program Director)
- May 2025: “Spreading the meaning of ‘Ibasho’ worldwide! Aiming for a society where everyone has a place”  
Moderator: Naoki Hashimoto (Glass Rock Co-Creation Coordinator)
- May 2025: “You and me. Us and nature. Let's talk about everyone's wellbeing”  
Moderator: Hiroaki Miyata (Professor at Keio University / Glass Rock Advisor)
- June 2025: “How to deal with climate change — our individual approaches”  
Moderator: Akiko Imai (Showa Women's University)
- June 2025: “Creating a sustainable city by getting more people involved”  
Moderator: Ryuta Kosuge (Glass Rock Co-Creation Coordinator)

*Note: Schedule, titles and speakers are subject to change.*

### **Collaboration with magmabooks (2nd and 3rd floors)**

New learning opportunities will be offered in collaboration with magmabooks, a new-style bookstore focused on encounters with knowledge. In addition to a corner for books related to societal issues targeted by the facility at Glass Rock, separate galleries in magmabooks and Glass Rock will be linked for a limited time to share information with the general public as a first step towards addressing key issues in society.

#### **About magmabooks**



Maruzen Junkudo, a major Japanese book retailer, will open magmabooks as a new type of bookstore that focuses on intellectual excitement and creativity, allowing people to enjoy the entire experience before, during and after reading. Magmabooks will be an experiential space designed for encounters with knowledge by facilitating concentration and relaxation through the Wall of Questions and Editing-type Bookshelves, named Forest of Knowledge, as well as the fee-based Zone Focus and Zone Reset lounges. Along with a permanent space on the 3rd floor where books are organized by genre, the 2nd floor will present new views and values through books organized by theme. The gallery will also host exhibitions and collaborative events.

**Wall of Questions:** Encounters with books linked by different ideas and questions

**Editing-type Bookshelves (Forest of knowledge):** Diverse genres, as in nature, arranged by theme

**Zone Focus:** Private workspaces where users can focus and work on important projects and issues

**Zone Reset:** Simple space with minimal visual information to relieve mental and physical tension

## Appendix 1: Overview of Toranomon Hills

Toranomon Hills Mori Tower was completed in the Toranomon Hills area in 2014, followed by Toranomon Hills Business Tower in 2020 and Toranomon Hills Residential Tower in 2022. In 2023, Toranomon Hills Station Tower was completed as a joint development with Toranomon Hills Station on the Tokyo Metro Hibiya Line, and in 2025, Glass Rock was added to expand the area to 7.5 ha and 800,000 m<sup>2</sup> total floor area.

Toranomon Hills' world-class offices, residences, hotels, commercial facilities, incubation centers, transportation infrastructure, green spaces and other urban functions, all within walking distance, are transforming the area into an international complex with an impact comparable to the groundbreaking Roppongi Hills as an international new urban center and global business center attracting global players to Tokyo and Japan.

### Gateway to Tokyo as a new transportation hub in the city center

Mori Tower, completed in 2014, uses an innovative multi-level road system to build structures over roads, including the integrated construction of the Loop Road No. 2 expressway and a skyscraper. The completion of Loop Road No. 2, which required 68 years to fully complete before opening in December 2022, has dramatically improved access between Tokyo's central, waterfront and Haneda Airport areas. Toranomon Hills Business Tower, which was completed in 2020, is directly connected via underground passageway to Toranomon Hills Station on the Hibiya Line and Toranomon Station on the Ginza Line. Also, on the first floor is a 1,000 m<sup>2</sup> bus terminal for airport "limousine buses" and the Tokyo BRT (bus rapid transit system), which connects Tokyo's central and waterfront areas.

The complex also has a barrier-free underground pedestrian walkway connecting Toranomon Station and Toranomon Hills Station, and a pedestrian deck connecting the towers in the complex. Furthermore, Toranomon Hills Station Tower, which was completed in 2023 through integrated development of the station and surrounding area, features the Station Atrium open-air plaza in front of the station, a first for a subway station in Japan, and a large 20-meter-wide pedestrian deck that spans Sakurada-dori (National Route No. 1) to connect with Mori Tower's Oval Plaza. Taken together, these various pedestrian enhancements significantly improve the overall walkability and vibrancy of the area.

Strengthened by increased flows of people and a pedestrian network that connects the entire area, the Toranomon Hills area is now poised to serve as a new gateway to Tokyo, connecting the world to the city center.

### Overview Area

Size: Approx. 7.5 ha	Residential units: Approx. 730
Total floor space: 800,000 m <sup>2</sup>	Retail space: 26,000 m <sup>2</sup>
Office space: 300,000 m <sup>2</sup>	Green space: 21,000 m <sup>2</sup>

### Elevation

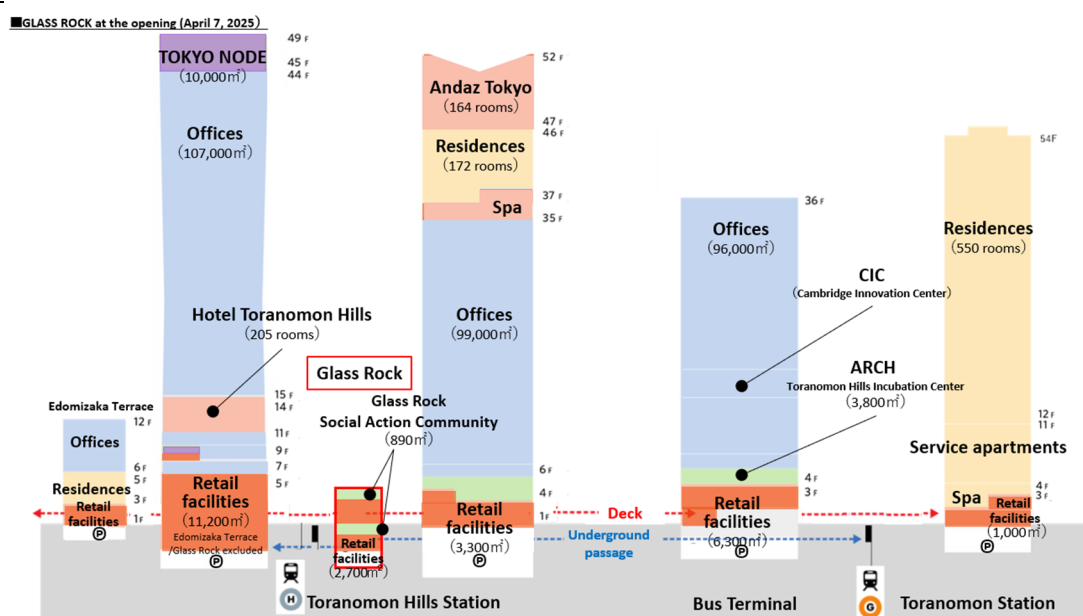

## Appendix 2: Building an Innovation Ecosystem

For Tokyo to succeed in global competition with other international cities, it must continuously generate innovation and support the development of its industries and urban society. Through various platforms, initiatives and outreach, Mori Building is fostering an ecosystem to drive innovation, contribute to new business formation and solve various societal challenges. The ultimate goal is to foster a city with magnetic appeal to attract people, businesses and knowledge, which in turn will further strengthen its magnetism, create new companies and business opportunities, and drive societal transformation.

### Overview of Innovation Ecosystem Facilities

#### • ARCH Toranomon Hills (Toranomon Hills Business Tower)

Established in April 2020 within the Business Tower, this incubation facility is dedicated to fostering new business creation for large corporations. As of March 2025, it is accommodating approximately 120 companies and 1,000 members. The facility focuses on the unique opportunities and challenges faced by large corporations with their abundant resources and networks. As a launchpad for new business creation, it offers services such as educational programs to impart innovation-supporting knowledge and mindsets, networking opportunities to facilitate idea creation, and mentoring by experienced professionals to strengthen solution initiatives. Through such services, the facility helps corporate teams transform innovative ideas into viable new businesses.

Supporting New Business Creation  
by Large Corporations



#### • CIC Tokyo (Toranomon Hills Business Tower)

CIC Tokyo is a 6,000 m<sup>2</sup> innovation hub and shared office space located on the 15th and 16th floors of Toranomon Hills Business Tower. As a springboard for global innovation, it is home to over 350 companies and hosts more than 600 events annually, including those organized by Venture Café and private gatherings. More than just an office space, it is designed to support the global growth of startups by fostering a vibrant community where innovators, investors and corporations from around the world can connect. The goal is to create an environment where promising startups receive timely and critical support to fuel continuous innovation.

Japan's Largest Innovation Community



#### • TOKYO NODE (Toranomon Hills Station Tower)

Located at the top of Station Tower, this 10,000 m<sup>2</sup> innovation hub is a new platform for global information and content dissemination. By breaking down traditional boundaries between business, art, entertainment, technology and fashion, it fosters diverse collaborations that generate new experiences, value and content that can be shared with the world. TOKYO NODE LAB brings together 11 leading innovative companies and individuals from various industries for collaborative projects aimed at building an ecosystem to drive the creation and dissemination of new urban experiences and cutting-edge content.

Platform for Innovation Driven by  
Cutting-edge Technology

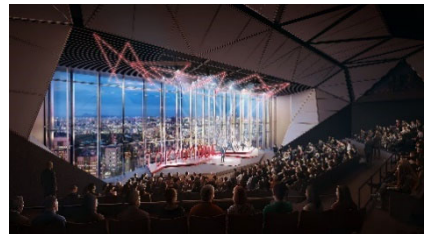

©DBOX for Mori Building Co., Ltd.



### •Toranomom Hills Forum (Toranomom Hills Mori Tower)

Located in Mori Tower overlooking Oval Plaza, this is the largest conference facility in the area. The venue features three column-free, modular halls with a capacity for some 2,000 guests. Seamlessly integrating a lobby, foyer, meeting rooms and café, it offers a highly sophisticated and private event space for hosting diverse programs, including international conferences and corporate events. The venue provides a platform for discussing business, strategy, technology and sustainability, bringing together leaders, practitioners and advocates from around the world to facilitate dialogue, exhibitions and the exchange of new insights, technologies and best practices.

#### Area's Largest Conference Facility

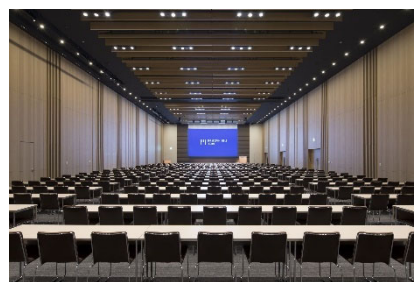

### •Tokyo Venture Capital Hub (Azabudai Hills)

This is Japan's first large-scale venture capital hub, bringing together approximately 70 independent VCs and corporate VCs (CVCs). In particular, the hub fosters collaboration and mutual growth between VCs and CVCs by actively involving independent VCs in study sessions and events that contribute to industry growth and the development of next-generation VCs. As a key source of risk capital essential for startup growth, it aims to serve as a catalyst for revitalizing Japan's economy.

#### Hub for Providing Risk Capital



### •Japan Innovation Campus (Silicon Valley, USA)

The Japan Innovation Campus in Silicon Valley is a business hub established under a project commissioned by Japan's Ministry of Economy, Trade, and Industry (METI) to support global entrepreneurship. It welcomes Japanese entrepreneurs and students while collaborating with local accelerators, venture capital firms, top universities, and government agencies to drive Japanese startups' global expansion and ecosystem growth. The campus also fosters connections between Japanese and U.S. startups, businesses and investors to promote open bilateral innovation.

#### U.S. Base for Japan-origin Startups



### About Mori Building

Mori Building is an innovative urban developer based in Tokyo. The company is committed to maximizing the magnetic power of cities by creating and nurturing safe, sustainable and cosmopolitan urban centers based on its unique Vertical Garden City concept of high-rise centers for business, education, leisure and residence. The concept is applied in the company's many leading-edge projects, including ARK Hills, Roppongi Hills, Toranomom Hills, and Azabudai Hills in Tokyo and the Shanghai World Financial Center. Mori Building is also engaged in real estate leasing, project management and consultation. Please visit [www.mori.co.jp/en](http://www.mori.co.jp/en)

### International media inquiries

Public Relations, Mori Building Co., Ltd.  
+81 (0)3 6406 6606  
[koho@mori.co.jp](mailto:koho@mori.co.jp)

Weber Shandwick Japan  
Mayuko Harada (+81 (0)90 9006 4968)  
Minako Momose (+81 (0)80 8751 8014)  
Masashi Nonaka (+81 (0)80 1037 7879)  
[moribldg@webershandwick.com](mailto:moribldg@webershandwick.com)